

SolarInnovate Energy Solutions

24v double-sided solar panel

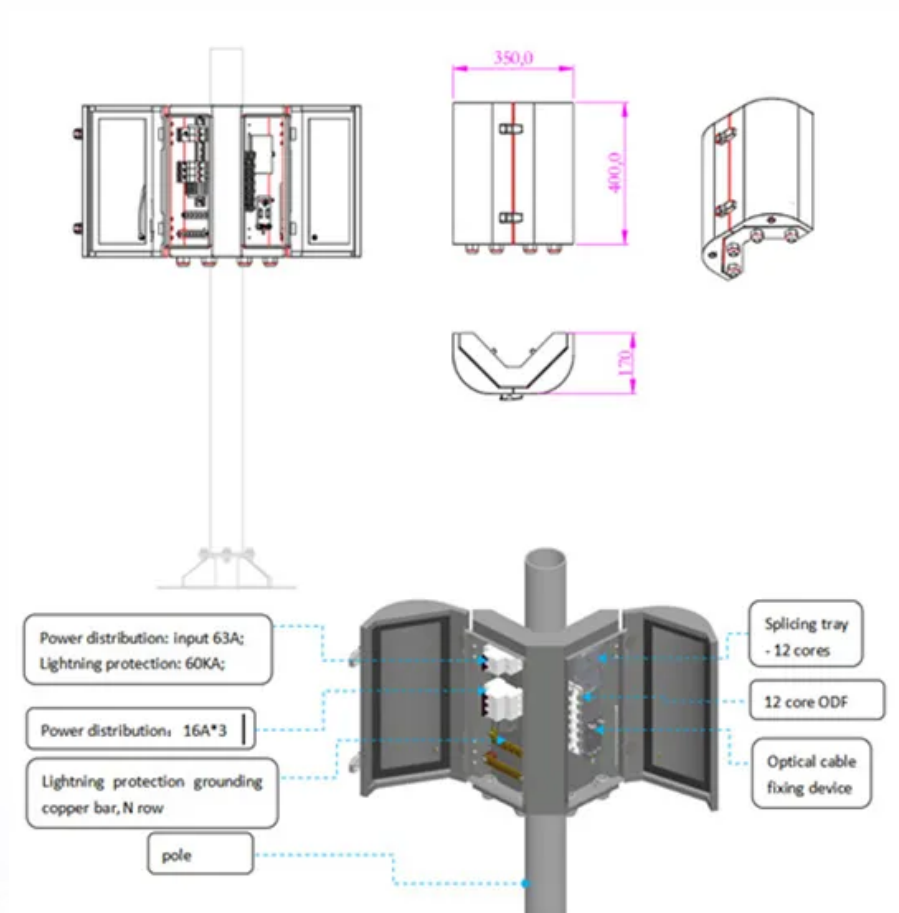

Overview

What is a double sided solar panel?

As the name suggests, it refers to a photovoltaic cell module formed by two pieces of glass and solar cells composed of a composite layer, and the cells are connected in series and connected in parallel to the lead ends. In recent years, double sided glass solar panels are like riding on a rocket, and their popularity is soaring.

What is a 24 volt solar panel?

A solar panel 24V is a versatile module for 24 volt systems. A solar panel 24 volt can be used in RV or boat solar installations. It's a great choice for a residential solar system. As a rule, when the need for electricity exceeds 2 kW, it is recommended to install 24V solar panels.

What is the difference between a 12V and 24V solar panel?

Keep in mind that when you are dealing with a 24 volt panel, it requires slightly different equipment than a 12V one. The reason for this is high solar panel output voltage, which goes up to 32V. To simplify the process, many manufacturers offer complete kits with all the equipment you need.

What are the different types of solar panels?

Most of the solar panels you see are mono-facial solar panels. Sunlight hits the top face of the solar panel, and it generates electricity. But those aren't the only kind of solar panel that is out there. There's another type - bifacial solar panels. With bifacial panels, an extra part of the solar panel produces electricity - the back face.

How do bifacial solar panels work?

By installing the bifacial solar panels over a reflective surface, the light can bounce back through the panel a second time, giving the cells on the backside of the panel a second chance to capture and convert energy.

Are bifacial solar panels better than monofacial panels?

The technology behind solar panels continues to evolve and improve. Manufacturers are now able to produce bifacial panels, which feature energy-producing solar cells on both sides of the panel. With two faces capable of absorbing sunlight, bifacial solar panels can be more efficient than traditional monofacial panels – if used appropriately.

24v double-sided solar panel



200W Bifacial Solar Panel, 9BB Monocrystalline, Dual-Sided ...

Aug 5, 2025 · Our panel features dual-sided solar cells and 18-busbar monocrystalline design, allowing it to absorb light from both sides and increase energy output by up to 25%, while ...

800W Bifacial Solar Panel, 9BB Monocrystalline, Dual-Sided ...

Aug 5, 2025 · The Rvpowwer 800W Bifacial Solar Panel is designed for users who need reliable energy in limited space. Thanks to its dual-sided design, the panel collects sunlight from both ...



Contact Us

For catalog requests, pricing, or partnerships, please visit:
<https://institut3i.fr>